

| BEAM MARKING | SIZE | REINFORCEMENT | AT MID-SPAN |
|--------------|-----------|-----------------------------|-----------------------------|
| B1 | 250 x 450 | 3 x 18 top 3 x 16 bottom | 2 x 18 top 2 x 16 bottom |
| B2 | 250 x 450 | 3 x 18 top 3 x 16 bottom | 2 x 18 top 2 x 16 bottom |
| B3 | 250 x 450 | 3 x 18 top 3 x 16 bottom | 2 x 18 top 2 x 16 bottom |
| B4 | 250 x 450 | 3 x 18 top 3 x 16 bottom | 2 x 18 top 2 x 16 bottom |
| B5 | 250 x 450 | 3 x 18 top 3 x 16 bottom | 2 x 18 top 2 x 16 bottom |
| B6 | 250 x 450 | 3 x 18 top 3 x 16 bottom | 2 x 18 top 2 x 16 bottom |
| B7 | 250 x 450 | 3 x 18 top 3 x 16 bottom | 2 x 18 top 2 x 16 bottom |
| B8 | 250 x 450 | 3 x 18 top 3 x 16 bottom | 2 x 18 top 2 x 16 bottom |
| B9 | 250 x 450 | 3 x 18 top 3 x 16 bottom | 2 x 18 top 2 x 16 bottom |
| B10 | 250 x 450 | 3 x 18 top 3 x 16 bottom | 2 x 18 top 2 x 16 bottom |
| B11 | 250 x 450 | 3 x 18 top 3 x 16 bottom | 2 x 18 top 2 x 16 bottom |
| B12 | 250 x 450 | 3 x 18 top 3 x 16 bottom | 2 x 18 top 2 x 16 bottom |
| B13 | 250 x 450 | 3 x 18 top 3 x 16 bottom | 2 x 18 top 2 x 16 bottom |
| B14 | 250 x 450 | 3 x 18 top 3 x 16 bottom | 2 x 18 top 2 x 16 bottom |
| B15 | 250 x 450 | 3 x 18 top 3 x 16 bottom | 2 x 18 top 2 x 16 bottom |
| B16 | 250 x 450 | 3 x 18 top 3 x 16 bottom | 2 x 18 top 2 x 16 bottom |
| B17 | 250 x 450 | 3 x 18 top 3 x 16 bottom | 2 x 18 top 2 x 16 bottom |
| B18 | 250 x 450 | 3 x 18 top 3 x 16 bottom | 2 x 18 top 2 x 16 bottom |
| B19 | 250 x 450 | 3 x 18 top 3 x 16 bottom | 2 x 18 top 2 x 16 bottom |
| B20 | 250 x 450 | 3 x 18 top 3 x 16 bottom | 2 x 18 top 2 x 16 bottom |
| B21 | 250 x 450 | 3 x 18 top 3 x 16 bottom | 2 x 18 top 2 x 16 bottom |
| B22 | 250 x 450 | 3 x 18 top 3 x 16 bottom | 2 x 18 top 2 x 16 bottom |
| B23 | 250 x 450 | 3 x 18 top 3 x 16 bottom | 2 x 18 top 2 x 16 bottom |
| B24 | 250 x 450 | 3 x 18 top 3 x 16 bottom | 2 x 18 top 2 x 16 bottom |
| B25 | 250 x 450 | 3 x 18 top 3 x 16 bottom | 2 x 18 top 2 x 16 bottom |
| B26 | 250 x 450 | 3 x 18 top 3 x 16 bottom | 2 x 18 top 2 x 16 bottom |
| B27 | 250 x 450 | 3 x 18 top 3 x 16 bottom | 2 x 18 top 2 x 16 bottom |
| B28 | 250 x 450 | 3 x 18 top 3 x 16 bottom | 2 x 18 top 2 x 16 bottom |
| B29 | 250 x 450 | 3 x 18 top 3 x 16 bottom | 2 x 18 top 2 x 16 bottom |
| B30 | 250 x 450 | 3 x 18 top 3 x 16 bottom | 2 x 18 top 2 x 16 bottom |
| B31 | 250 x 450 | 3 x 18 top 3 x 16 bottom | 2 x 18 top 2 x 16 bottom |
| B32 | 250 x 450 | 3 x 18 top 3 x 16 bottom | 2 x 18 top 2 x 16 bottom |
| B33 | 250 x 450 | 3 x 18 top 3 x 16 bottom | 2 x 18 top 2 x 16 bottom |
| B34 | 250 x 450 | 3 x 18 top 3 x 16 bottom | 2 x 18 top 2 x 16 bottom |
| B35 | 250 x 450 | 3 x 18 top 3 x 16 bottom | 2 x 18 top 2 x 16 bottom |
| B36 | 250 x 450 | 3 x 18 top 3 x 16 bottom | 2 x 18 top 2 x 16 bottom |
| B37 | 250 x 450 | 3 x 18 top 3 x 16 bottom | 2 x 18 top 2 x 16 bottom |
| B38 | 250 x 450 | 3 x 18 top 3 x 16 bottom | 2 x 18 top 2 x 16 bottom |
| B39 | 250 x 450 | 3 x 18 top 3 x 16 bottom | 2 x 18 top 2 x 16 bottom |
| B40 | 250 x 450 | 3 x 18 top 3 x 16 bottom | 2 x 18 top 2 x 16 bottom |
| B41 | 250 x 450 | 3 x 18 top 3 x 16 bottom | 2 x 18 top 2 x 16 bottom |
| B42 | 250 x 450 | 3 x 18 top 3 x 16 bottom | 2 x 18 top 2 x 16 bottom |
| B43 | 250 x 450 | 3 x 18 top 3 x 16 bottom | 2 x 18 top 2 x 16 bottom |
| B44 | 250 x 450 | 3 x 18 top 3 x 16 bottom | 2 x 18 top 2 x 16 bottom |
| B45 | 250 x 450 | 3 x 18 top 3 x 16 bottom | 2 x 18 top 2 x 16 bottom |
| B46 | 250 x 450 | 3 x 18 top 3 x 16 bottom | 2 x 18 top 2 x 16 bottom |
| B47 | 250 x 450 | 3 x 18 top 3 x 16 bottom | 2 x 18 top 2 x 16 bottom |
| B48 | 250 x 450 | 3 x 18 top 3 x 16 bottom | 2 x 18 top 2 x 16 bottom |
| B49 | 250 x 450 | 3 x 18 top 3 x 16 bottom | 2 x 18 top 2 x 16 bottom |
| B50 | 250 x 450 | 3 x 18 top 3 x 16 bottom | 2 x 18 top 2 x 16 bottom |
| B51 | 250 x 450 | 3 x 18 top 3 x 16 bottom | 2 x 18 top 2 x 16 bottom |
| B52 | 250 x 450 | 3 x 18 top 3 x 16 bottom | 2 x 18 top 2 x 16 bottom |
| B53 | 250 x 450 | 3 x 18 top 3 x 16 bottom | 2 x 18 top 2 x 16 bottom |
| B54 | 250 x 450 | 3 x 18 top 3 x 16 bottom | 2 x 18 top 2 x 16 bottom |
| B55 | 250 x 450 | 3 x 18 top 3 x 16 bottom | 2 x 18 top 2 x 16 bottom |
| B56 | 250 x 450 | 3 x 18 top 3 x 16 bottom | 2 x 18 top 2 x 16 bottom |
| B57 | 250 x 450 | 3 x 18 top 3 x 16 bottom | 2 x 18 top 2 x 16 bottom |
| B58 | 250 x 450 | 3 x 18 top 3 x 16 bottom | 2 x 18 top 2 x 16 bottom |
| B59 | 250 x 450 | 3 x 18 top 3 x 16 bottom | 2 x 18 top 2 x 16 bottom |
| B60 | 250 x 450 | 3 x 18 top 3 x 16 bottom | 2 x 18 top 2 x 16 bottom |
| B61 | 250 x 450 | 3 x 18 top 3 x 16 bottom | 2 x 18 top 2 x 16 bottom |
| B62 | 250 x 450 | 3 x 18 top 3 x 16 bottom | 2 x 18 top 2 x 16 bottom |
| B63 | 250 x 450 | 3 x 18 top 3 x 16 bottom | 2 x 18 top 2 x 16 bottom |
| B64 | 250 x 450 | 3 x 18 top 3 x 16 bottom | 2 x 18 top 2 x 16 bottom |
| B65 | 250 x 450 | 3 x 18 top 3 x 16 bottom | 2 x 18 top 2 x 16 bottom |
| B66 | 250 x 450 | 3 x 18 top 3 x 16 bottom | 2 x 18 top 2 x 16 bottom |
| B67 | 250 x 450 | 3 x 18 top 3 x 16 bottom | 2 x 18 top 2 x 16 bottom |
| B68 | 250 x 450 | 3 x 18 top 3 x 16 bottom | 2 x 18 top 2 x 16 bottom |
| B69 | 250 x 450 | 3 x 18 top 3 x 16 bottom | 2 x 18 top 2 x 16 bottom |
| B70 | 250 x 450 | 3 x 18 top 3 x 16 bottom | 2 x 18 top 2 x 16 bottom |
| B71 | 250 x 450 | 3 x 18 top 3 x 16 bottom | 2 x 18 top 2 x 16 bottom |
| B72 | 250 x 450 | 3 x 18 top 3 x 16 bottom | 2 x 18 top 2 x 16 bottom |
| B73 | 250 x 450 | 3 x 18 top 3 x 16 bottom | 2 x 18 top 2 x 16 bottom |
| B74 | 250 x 450 | 3 x 18 top 3 x 16 bottom | 2 x 18 top 2 x 16 bottom |
| B75 | 250 x 450 | 3 x 18 top 3 x 16 bottom | 2 x 18 top 2 x 16 bottom |
| B76 | 250 x 450 | 3 x 18 top 3 x 16 bottom | 2 x 18 top 2 x 16 bottom |
| B77 | 250 x 450 | 3 x 18 top 3 x 16 bottom | 2 x 18 top 2 x 16 bottom |
| B78 | 250 x 450 | 3 x 18 top 3 x 16 bottom | 2 x 18 top 2 x 16 bottom |
| B79 | 250 x 450 | 3 x 18 top 3 x 16 bottom | 2 x 18 top 2 x 16 bottom |
| B80 | 250 x 450 | 3 x 18 top 3 x 16 bottom | 2 x 18 top 2 x 16 bottom |
| B81 | 250 x 450 | 3 x 18 top 3 x 16 bottom | 2 x 18 top 2 x 16 bottom |
| B82 | 250 x 450 | 3 x 18 top 3 x 16 bottom | 2 x 18 top 2 x 16 bottom |
| B83 | 250 x 450 | 3 x 18 top 3 x 16 bottom | 2 x 18 top 2 x 16 bottom |
| B84 | 250 x 450 | 3 x 18 top 3 x 16 bottom | 2 x 18 top 2 x 16 bottom |
| B85 | 250 x 450 | 3 x 18 top 3 x 16 bottom | 2 x 18 top 2 x 16 bottom |
| B86 | 250 x 450 | 3 x 18 top 3 x 16 bottom | 2 x 18 top 2 x 16 bottom |
| B87 | 250 x 450 | 3 x 18 top 3 x 16 bottom | 2 x 18 top 2 x 16 bottom |
| B88 | 250 x 450 | 3 x 18 top 3 x 16 bottom | 2 x 18 top 2 x 16 bottom |
| B89 | 250 x 450 | 3 x 18 top 3 x 16 bottom | 2 x 18 top 2 x 16 bottom |
| B90 | 250 x 450 | 3 x 18 top 3 x 16 bottom | 2 x 18 top 2 x 16 bottom |
| B91 | 250 x 450 | 3 x 18 top 3 x 16 bottom | 2 x 18 top 2 x 16 bottom |
| B92 | 250 x 450 | 3 x 18 top 3 x 16 bottom | 2 x 18 top 2 x 16 bottom |
| B93 | 250 x 450 | 3 x 18 top 3 x 16 bottom | 2 x 18 top 2 x 16 bottom |
| B94 | 250 x 450 | 3 x 18 top 3 x 16 bottom | 2 x 18 top 2 x 16 bottom |
| B95 | 250 x 450 | 3 x 18 top 3 x 16 bottom | 2 x 18 top 2 x 16 bottom |
| B96 | 250 x 450 | 3 x 18 top 3 x 16 bottom | 2 x 18 top 2 x 16 bottom |
| B97 | 250 x 450 | 3 x 18 top 3 x 16 bottom | 2 x 18 top 2 x 16 bottom |
| B98 | 250 x 450 | 3 x 18 top 3 x 16 bottom | 2 x 18 top 2 x 16 bottom |
| B99 | 250 x 450 | 3 x 18 top 3 x 16 bottom | 2 x 18 top 2 x 16 bottom |
| B100 | 250 x 450 | 3 x 18 top 3 x 16 bottom | 2 x 18 top 2 x 16 bottom |

| SLAB MARKING | SIZE | REINFORCEMENT | AT MID-SPAN | AT SUPPORT |
|--------------|------|-----------------------------|-----------------------------|-----------------------------|
| S1 | 120 | 3 x 18 top 3 x 16 bottom | 2 x 18 top 2 x 16 bottom | 2 x 18 top 2 x 16 bottom |
| S2 | 120 | 3 x 18 top 3 x 16 bottom | 2 x 18 top 2 x 16 bottom | 2 x 18 top 2 x 16 bottom |
| S3 | 120 | 3 x 18 top 3 x 16 bottom | 2 x 18 top 2 x 16 bottom | 2 x 18 top 2 x 16 bottom |
| S4 | 130 | 3 x 18 top 3 x 16 bottom | 2 x 18 top 2 x 16 bottom | 2 x 18 top 2 x 16 bottom |
| S5 | 175 | 3 x 18 top 3 x 16 bottom | 2 x 18 top 2 x 16 bottom | 2 x 18 top 2 x 16 bottom |
| S6 | 140 | 3 x 18 top 3 x 16 bottom | 2 x 18 top 2 x 16 bottom | 2 x 18 top 2 x 16 bottom |

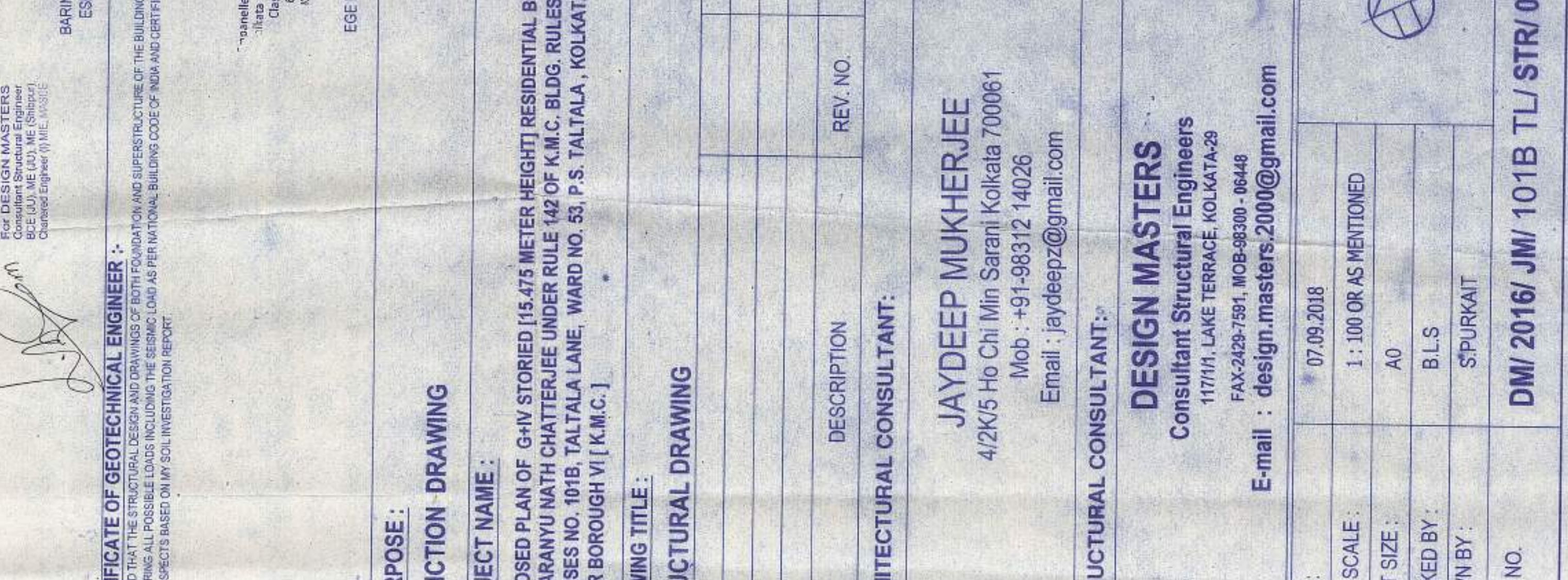
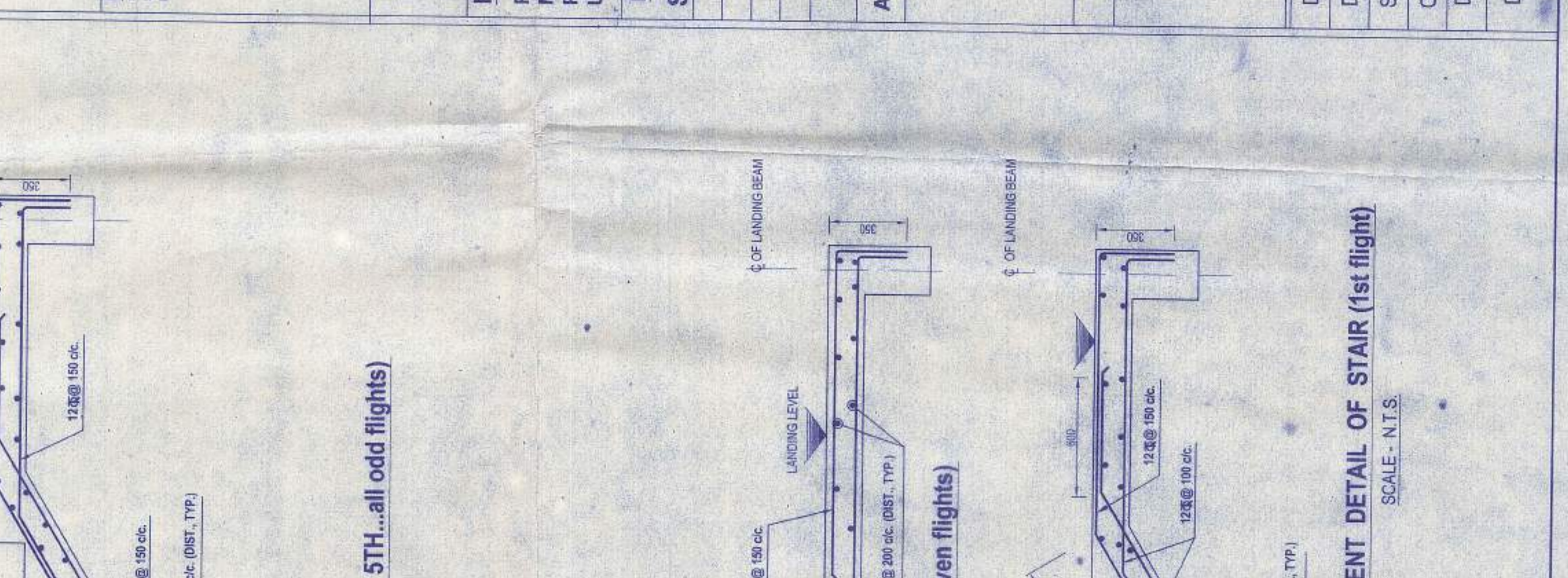
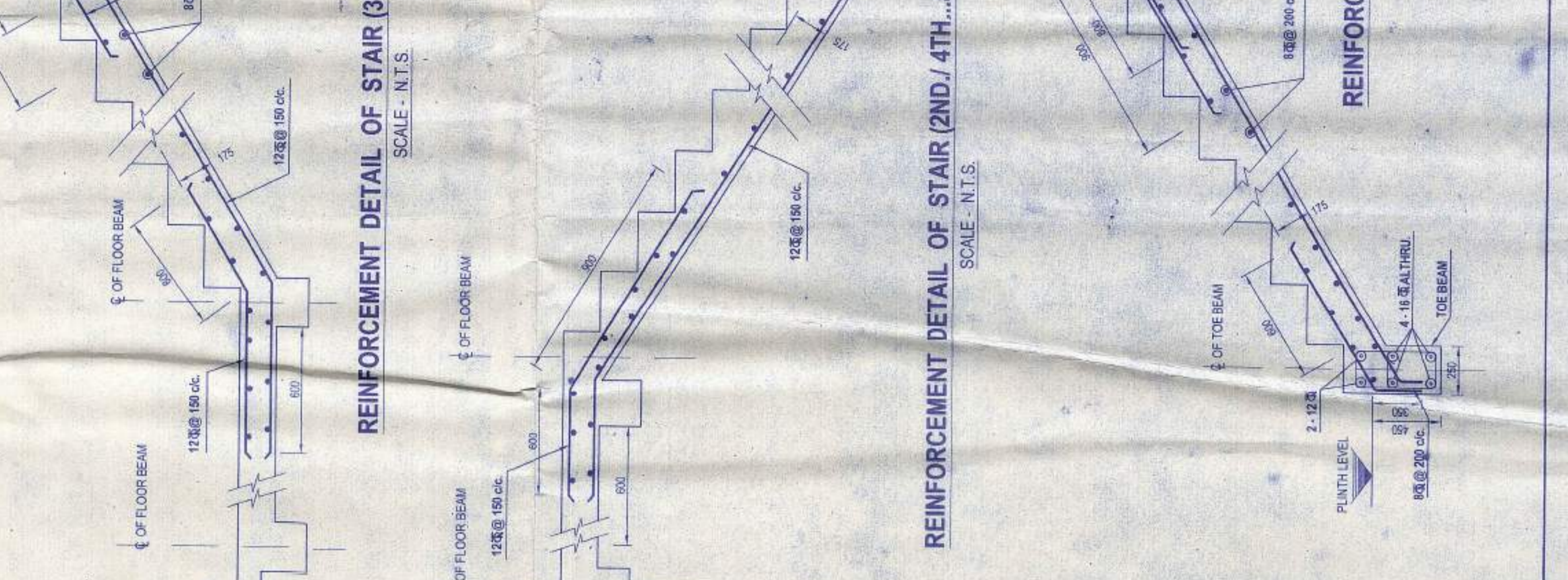
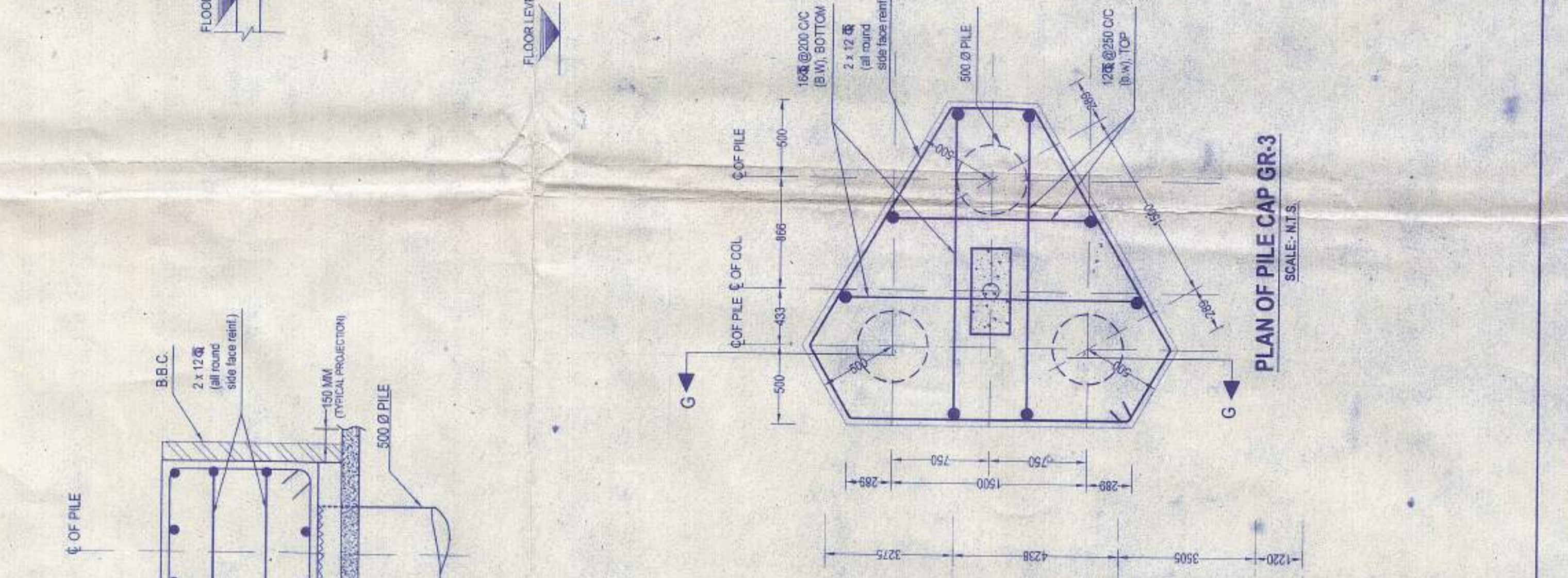
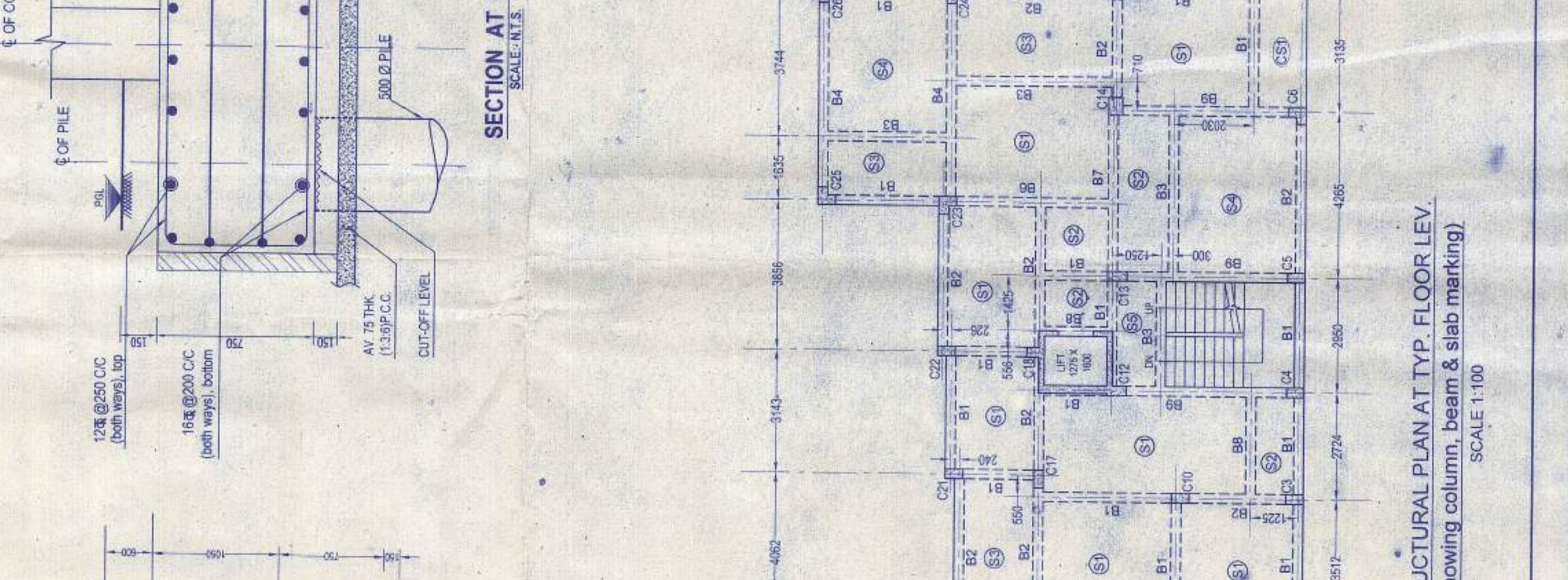
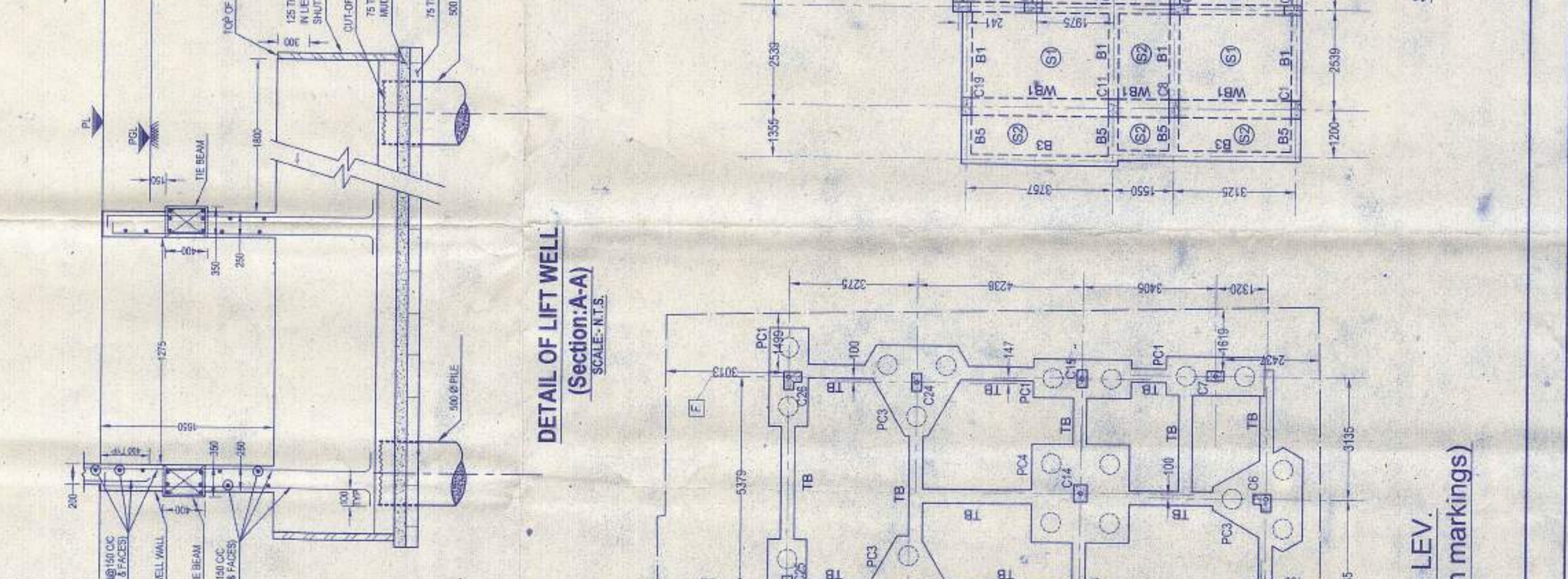
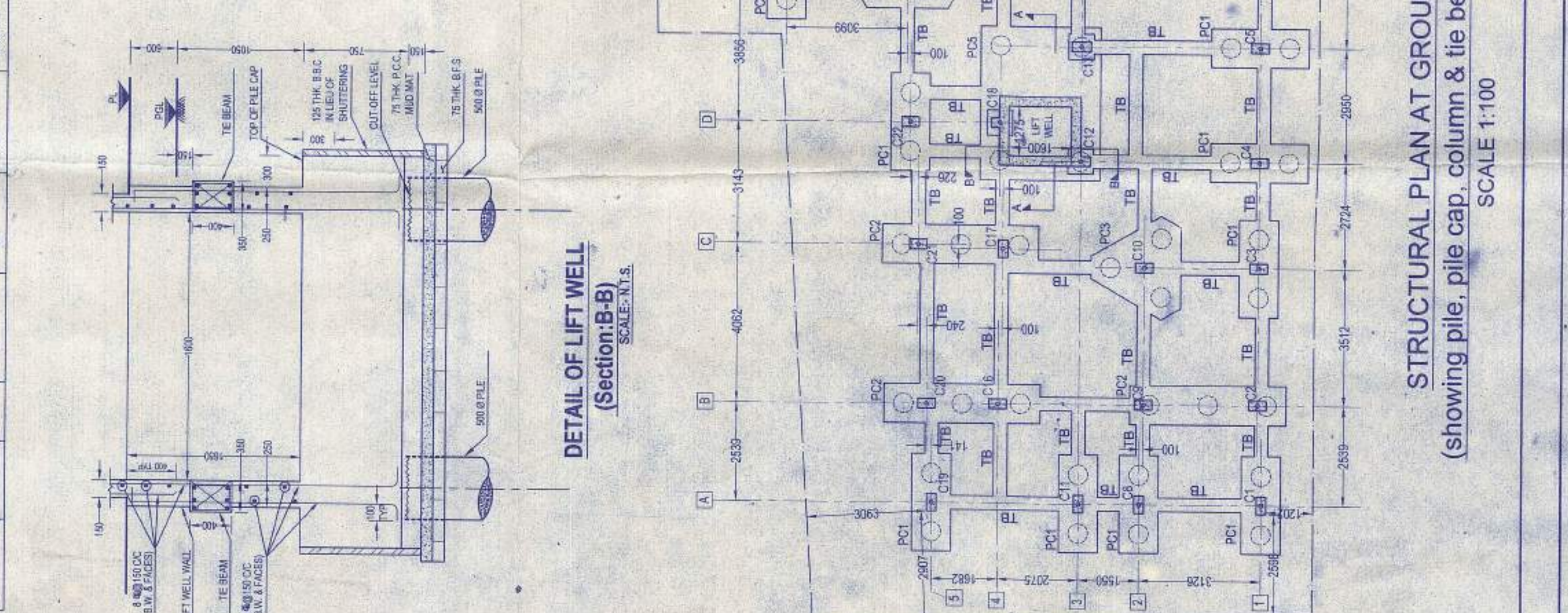

| COLUMN MARKING | SIZE | UP TO 1ST FLOOR LEVEL | UP TO 2ND FLOOR LEVEL | UP TO 3RD FLOOR LEVEL | UP TO 4TH FLOOR LEVEL | UP TO 5TH FLOOR LEVEL | UP TO ROOF LEVEL |
|--|-----------|-----------------------|-----------------------|-----------------------|-----------------------|-----------------------|------------------|
| C1, C2, C3 | 250 x 450 | 4 x 20 | 4 x 20 | 4 x 20 | 4 x 20 | 4 x 20 | 4 x 20 |
| C4 | 300 x 450 | 4 x 20 | 4 x 20 | 4 x 20 | 4 x 20 | 4 x 20 | 4 x 20 |
| C5, C6, C7, C8, C9, C10, C11, C12, C13, C14, C15, C16, C17, C18, C19, C20, C21, C22, C23, C24, C25, C26, C27, C28, C29, C30, C31, C32, C33, C34, C35, C36, C37, C38, C39, C40, C41, C42, C43, C44, C45, C46, C47, C48, C49, C50, C51, C52, C53, C54, C55, C56, C57, C58, C59, C60, C61, C62, C63, C64, C65, C66, C67, C68, C69, C70, C71, C72, C73, C74, C75, C76, C77, C78, C79, C80, C81, C82, C83, C84, C85, C86, C87, C88, C89, C90, C91, C92, C93, C94, C95, C96, C97, C98, C99, C100 | 250 x 450 | 4 x 20 | 4 x 20 | 4 x 20 | 4 x 20 | 4 x 20 | 4 x 20 |

| SYMBOL, ABBREVIATION & PREFIX | ITEMS OR DESCRIPTIONS |
|-------------------------------|-------------------------------|
| PC | PILE CAP |
| C | COLUMN |
| TB | TIE BEAM |
| S | SLAB |
| WB | WIDE BEAM |
| B | BEAM |
| PGL | PROPOSED GROUND LEVEL |
| BBC | BRICK BLOCKING COURSE |
| PCC | PLAIN CEMENT CONCRETE |
| BFS | BRICK FLAT SOLING |
| ⊕ | CENTRE POINT OF COLUMN |
| ⊙ | LEVEL MARKER AT VERTICAL FACE |

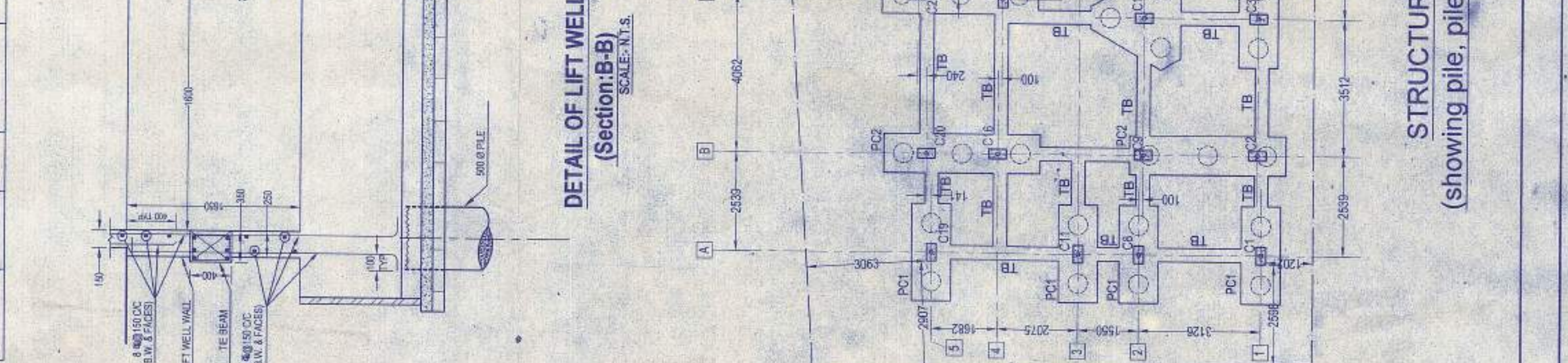
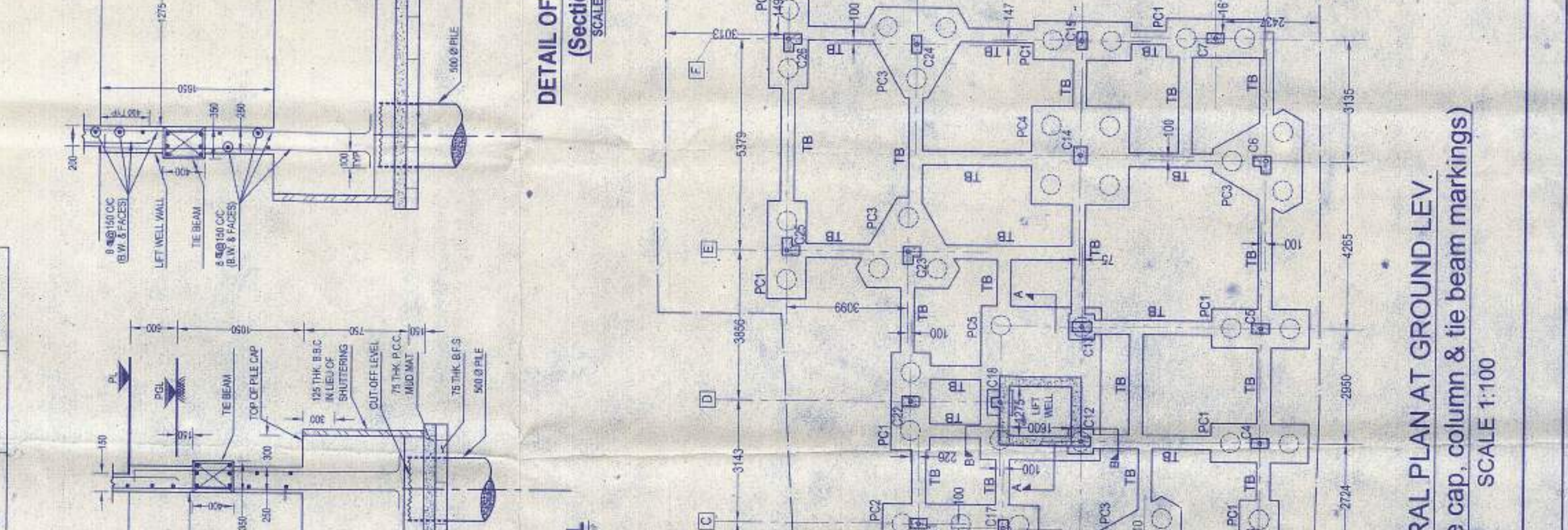
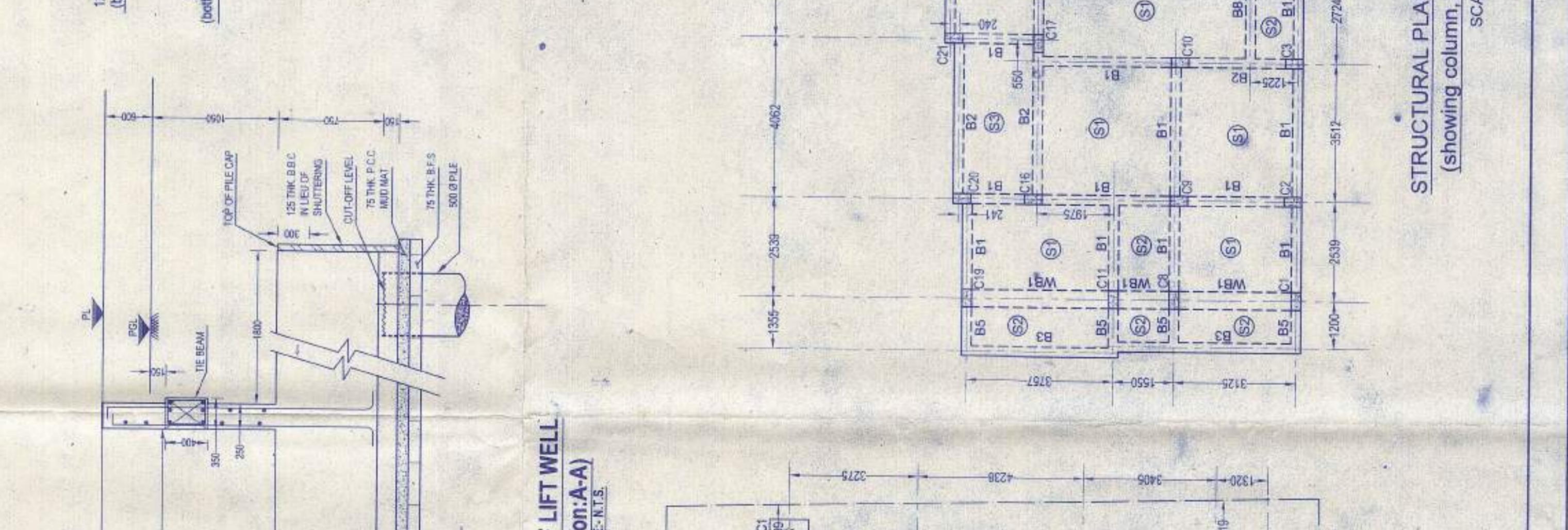
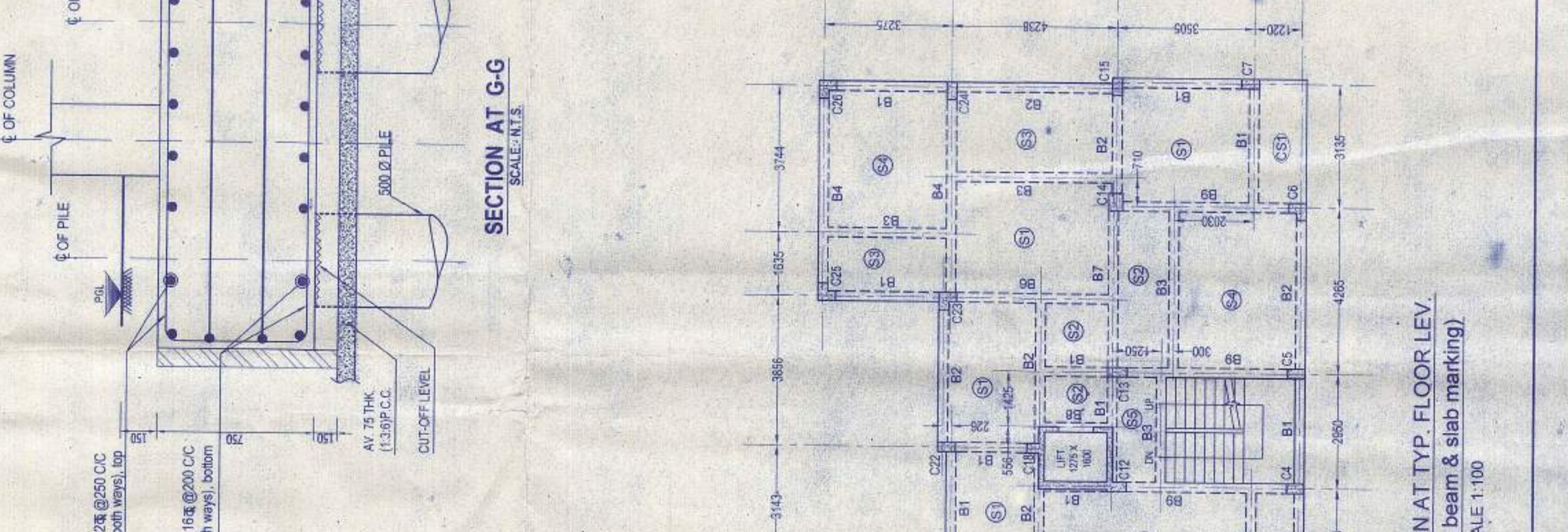
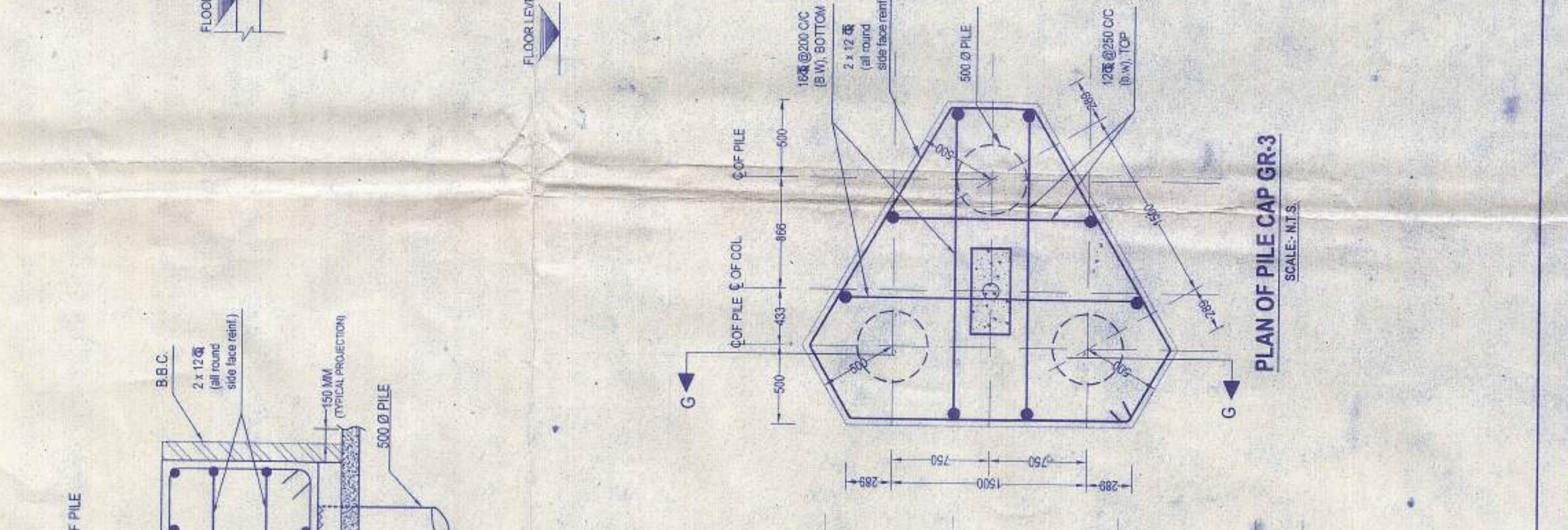
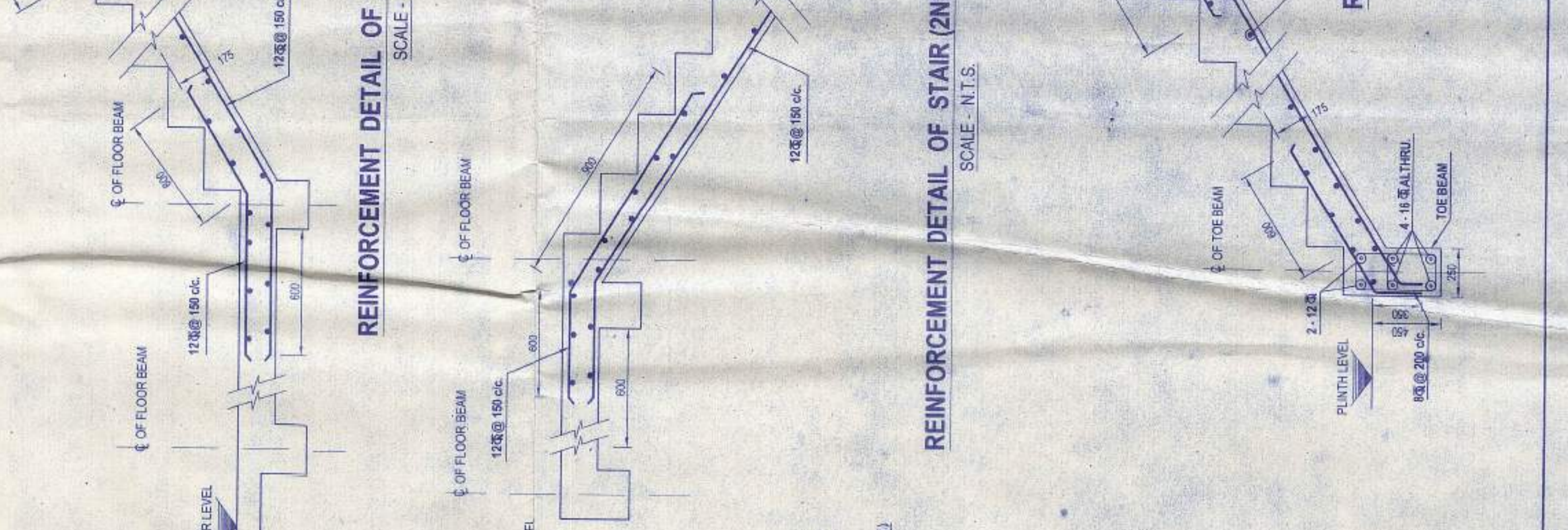
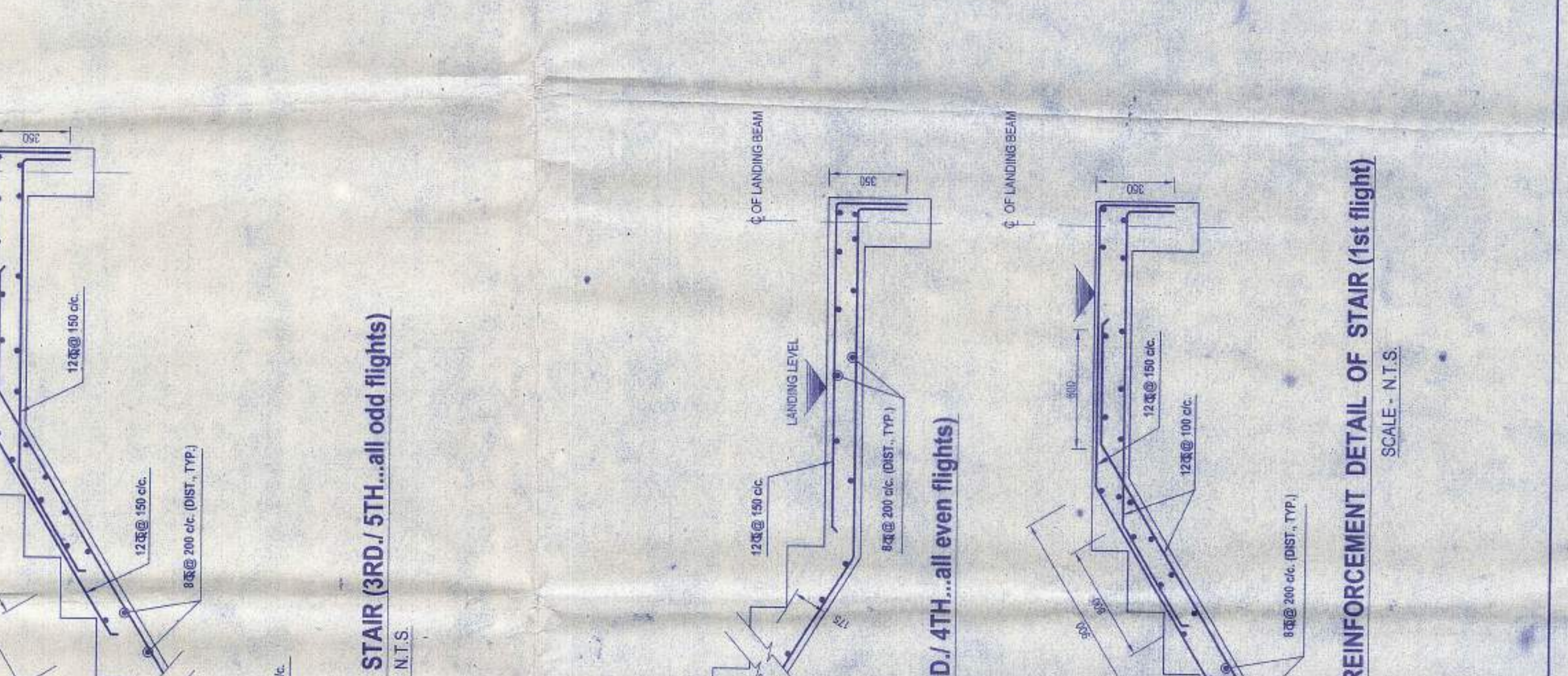
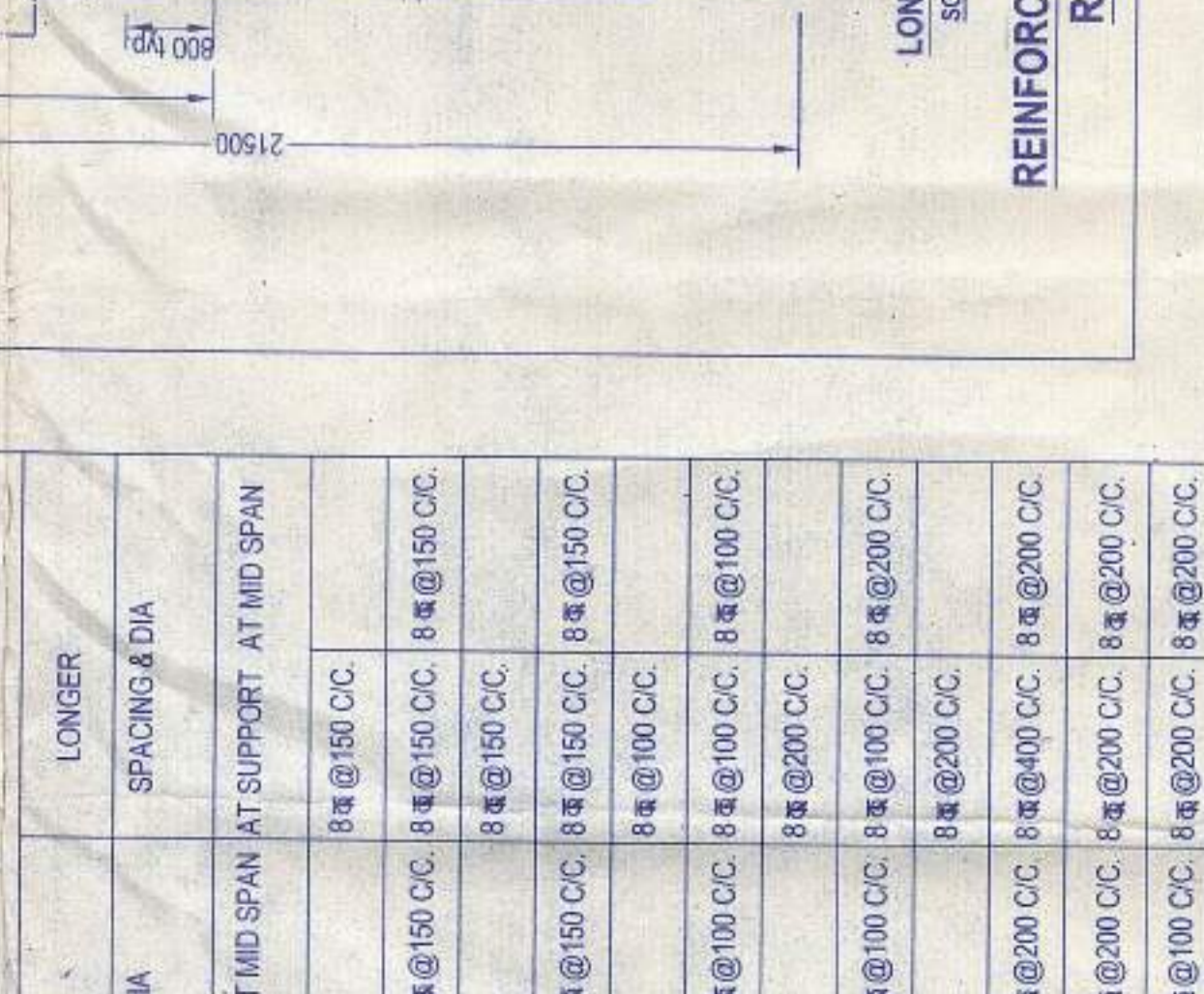
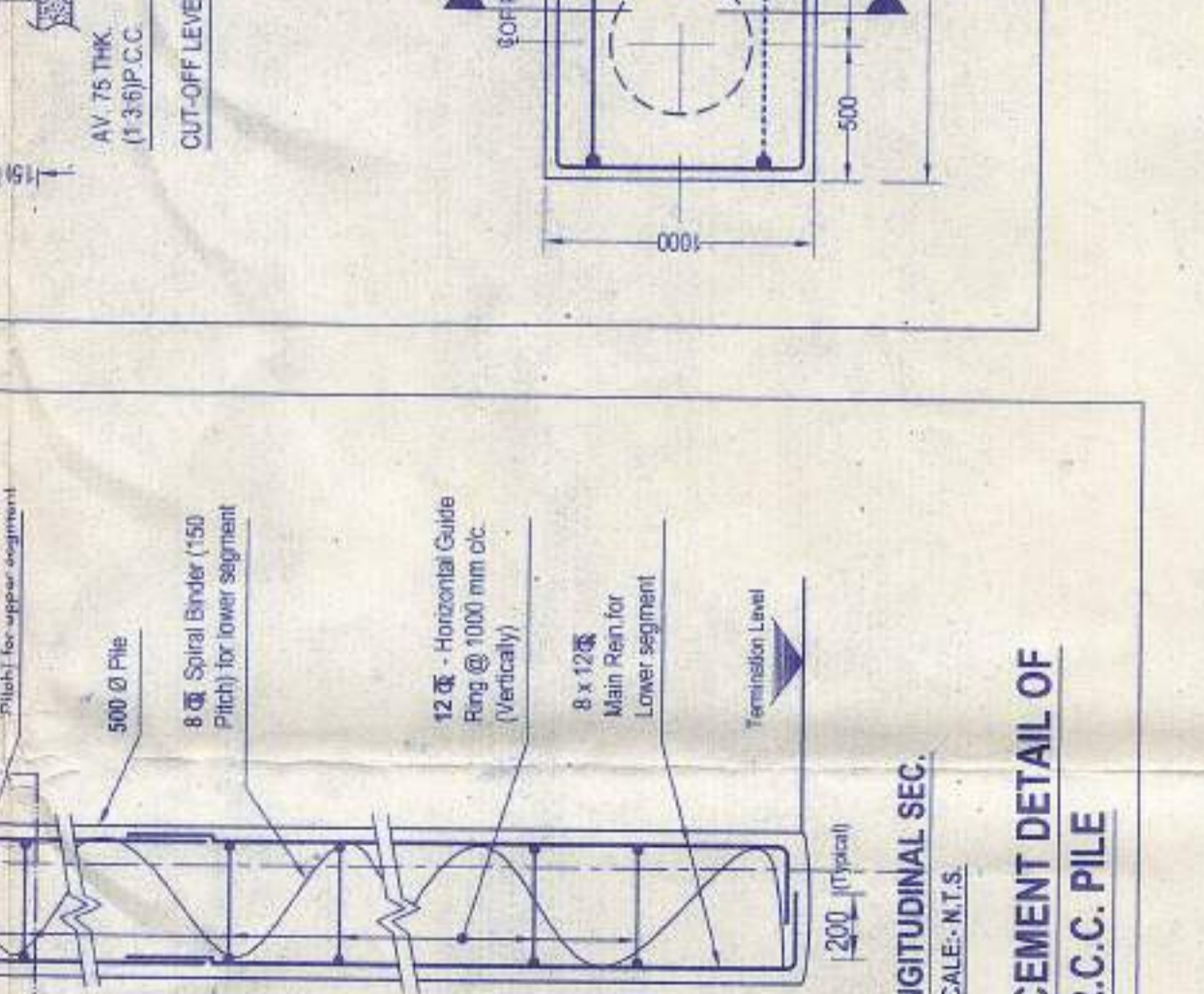
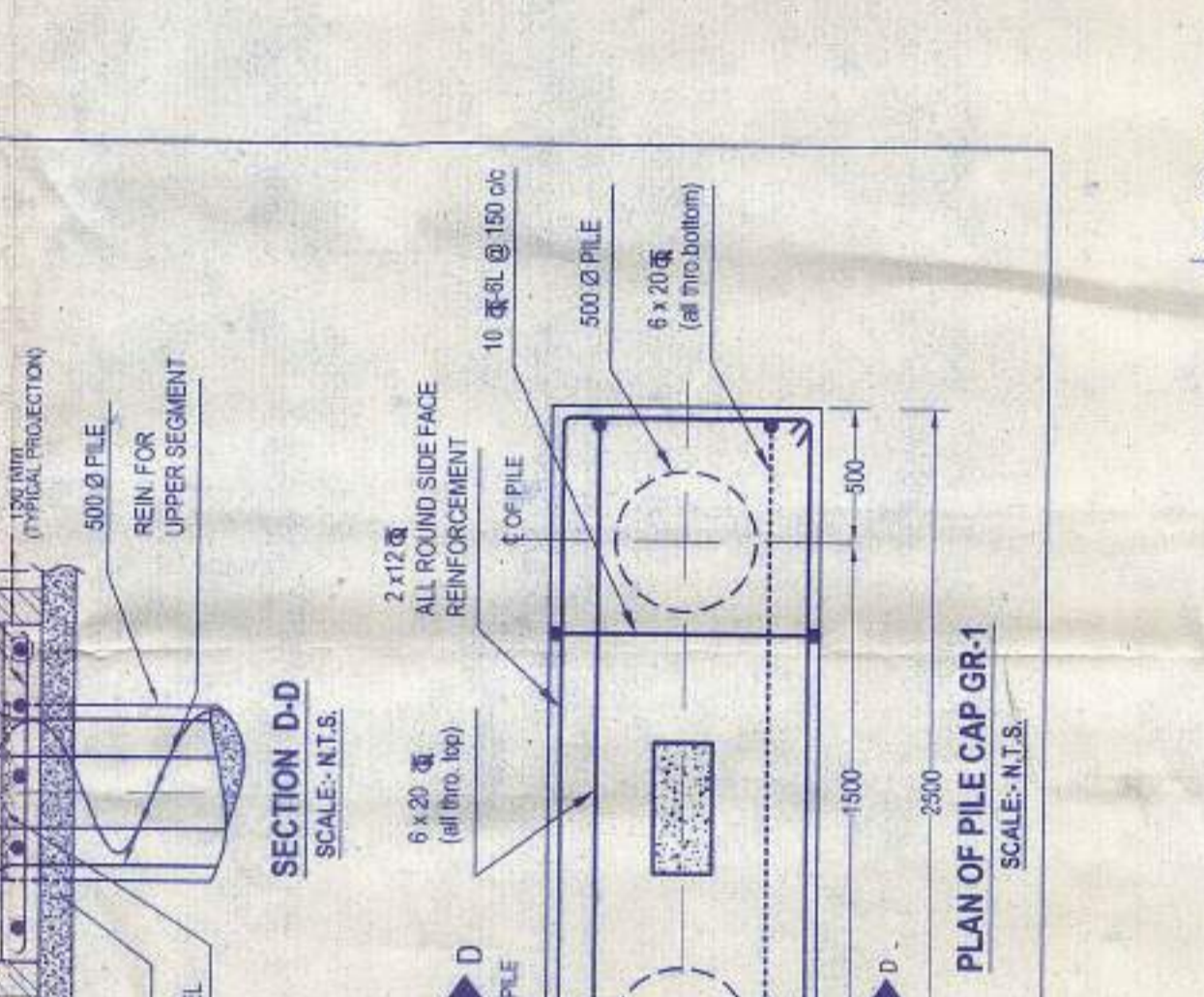
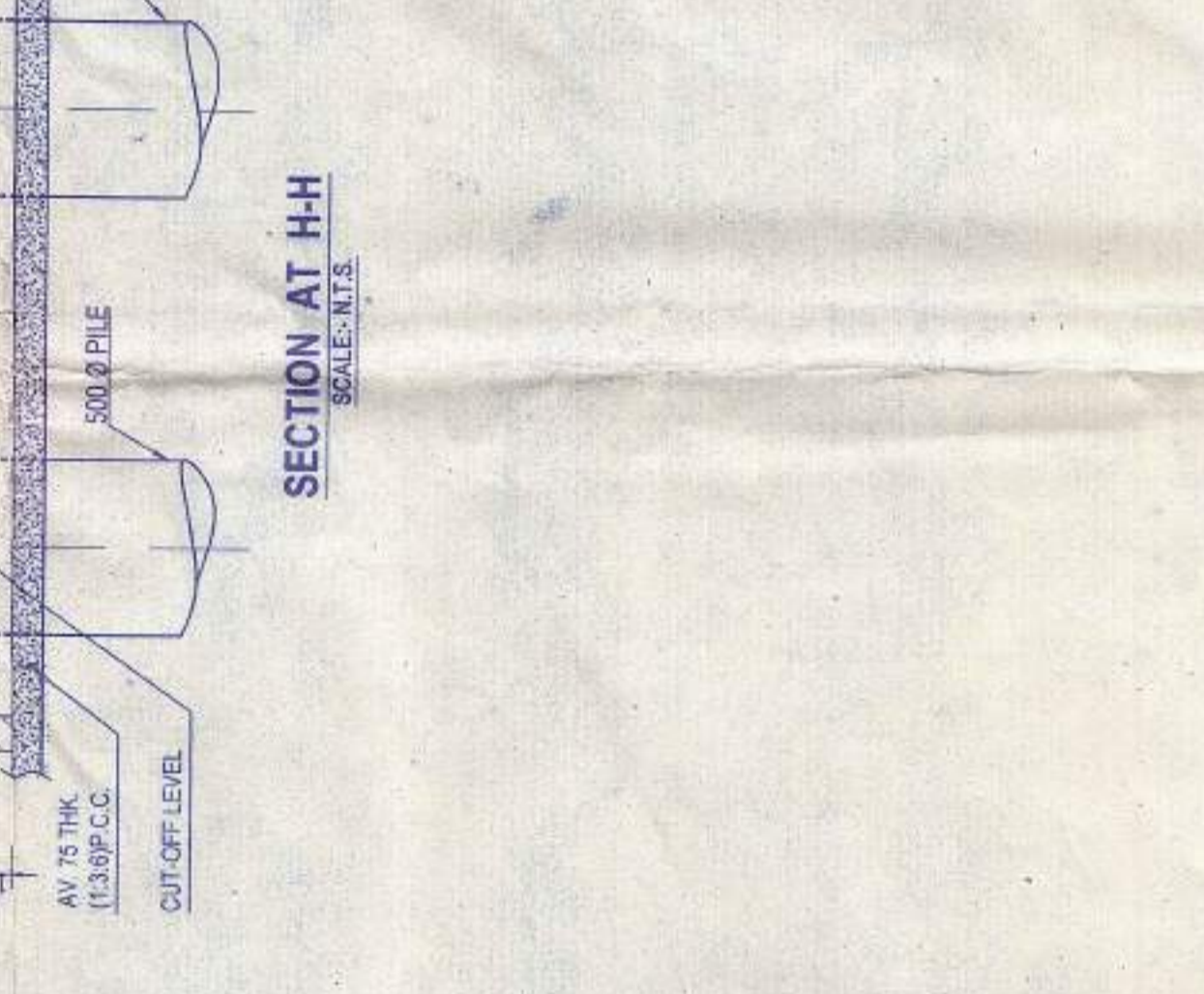
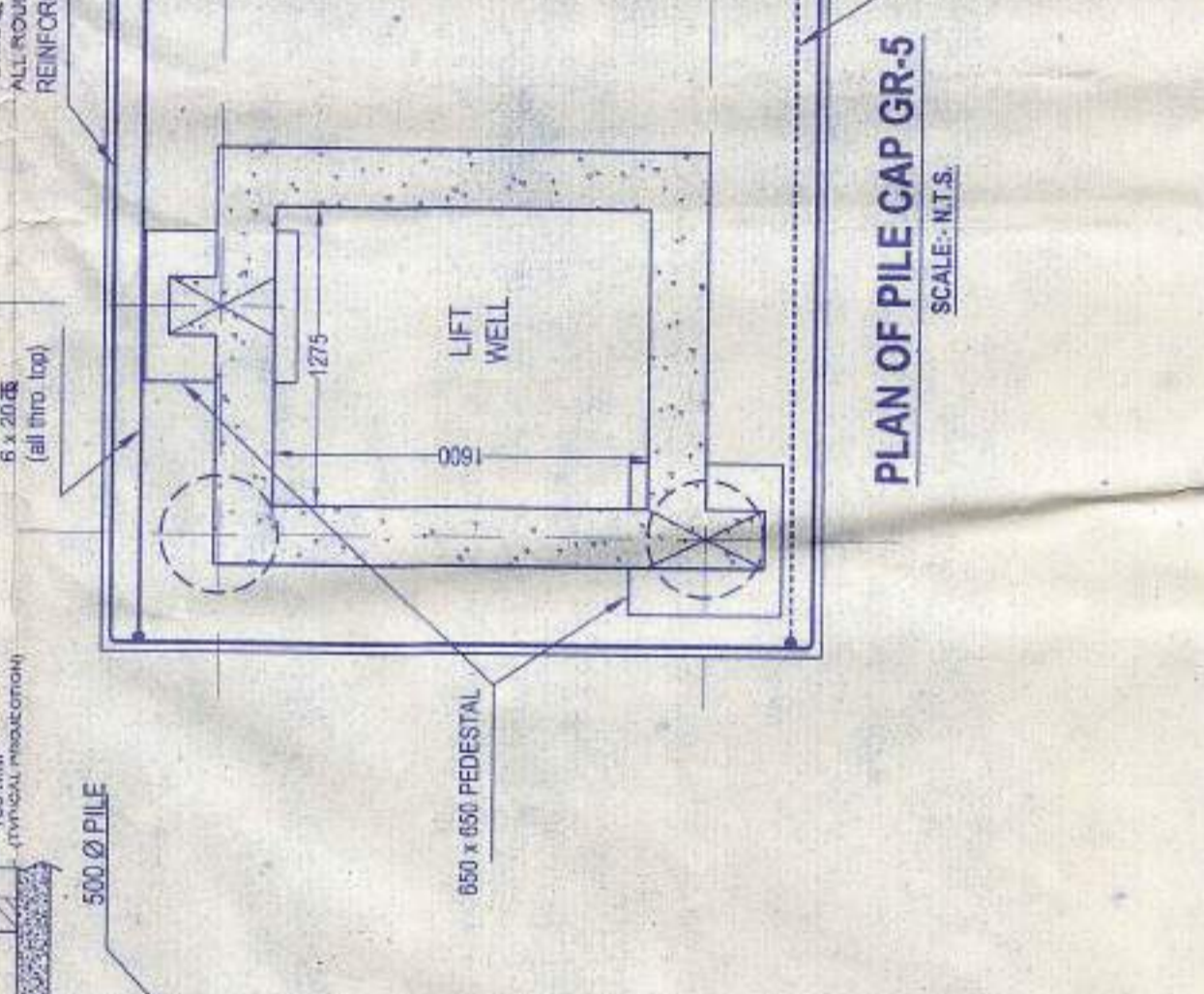
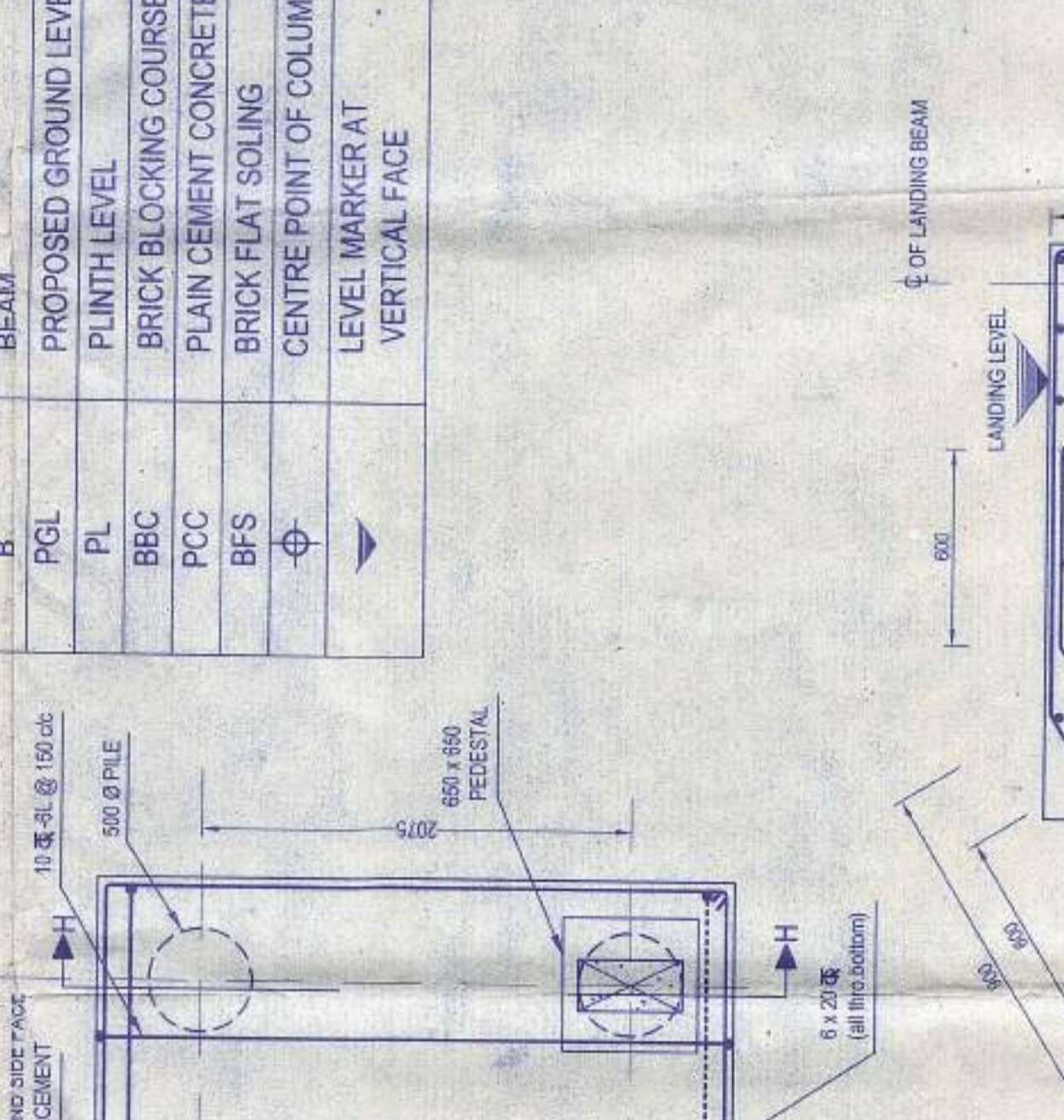

NOTES

- CONTRACTOR TO CHECK & VERIFY ALL DIMENSIONS BEFORE EXECUTION OF WORK.
- ALL DIMENSIONS ARE IN MILLIMETER, UNLESS OTHERWISE MENTIONED.
- ONLY FIGURED DIMENSIONS SHOULD BE FOLLOWED.
- GRADE OF STEEL USED IS Fe 500 TMT BAR AND GRADE OF CONCRETE IS M20.
- CLEAR COVER TO MAIN REINFORCEMENT TO:
 - SLAB IS 20 MM.
 - BEAM IS 35 MM.
 - COLUMN IS 45 MM.
 - PILE CAP IS 50 MM.
 - PILE IS 50 MM.
- LAP LENGTH TO BE CONSIDERED:

| | |
|----|------|
| 6 | 300 |
| 8 | 400 |
| 10 | 500 |
| 12 | 600 |
| 16 | 800 |
| 20 | 1000 |
| 25 | 1250 |
- PLAIN CEMENT CONCRETE WITH BRICK KHOLA IN 1:3:6 RATIO.
- WATER TIGHT SHUTTERING HAS TO BE ENSURED DURING CONSTRUCTION.
- ALL SLAB MUST BE CAST MONOLITHIC WITH SUPPORTING BEAM.
- ALL OTHER SPECIFICATIONS ARE AS PER M.C. OF INDIA.
- ALL PILES ARE R.C.G BORED CAST-IN-SITU METHOD D.M.C.
- CAPACITY OF PILE: 50 TON.
- ONE WORKING PILE SHOULD BE TESTED AS PER IS: 2911, Part - IV.
- CUT OFF LEVEL OF PILE UNDER LIFT PIT 1200.
- THIS DRAWING IS THE SOLE PROPERTY OF THE CONSULTANT & NO COPY OF IT SHOULD BE MADE WITHOUT THE WRITTEN PERMISSION FROM THE CONSULTANT.

CERTIFICATE OF OWNER
I, THE UNDERSIGNED, HAVE READ AND UNDERSTOOD THE ENTIRE CONTENTS OF THE ABOVE MENTIONED DRAWING AND SPECIFICATIONS AND I HEREBY CERTIFY THAT THE SAME ARE COMPLETELY ACCORDING TO THE REQUIREMENTS OF THE PROJECT AND I HAVE NO OBJECTION TO THE SAME. I HAVE ALSO READ AND UNDERSTOOD THE ENTIRE CONTENTS OF THE ABOVE MENTIONED DRAWING AND SPECIFICATIONS AND I HEREBY CERTIFY THAT THE SAME ARE COMPLETELY ACCORDING TO THE REQUIREMENTS OF THE PROJECT AND I HAVE NO OBJECTION TO THE SAME.

Signature: _____
Name: _____
Designation: _____
Address: _____

CERTIFICATE OF ARCHITECT
I, THE UNDERSIGNED, HAVE READ AND UNDERSTOOD THE ENTIRE CONTENTS OF THE ABOVE MENTIONED DRAWING AND SPECIFICATIONS AND I HEREBY CERTIFY THAT THE SAME ARE COMPLETELY ACCORDING TO THE REQUIREMENTS OF THE PROJECT AND I HAVE NO OBJECTION TO THE SAME. I HAVE ALSO READ AND UNDERSTOOD THE ENTIRE CONTENTS OF THE ABOVE MENTIONED DRAWING AND SPECIFICATIONS AND I HEREBY CERTIFY THAT THE SAME ARE COMPLETELY ACCORDING TO THE REQUIREMENTS OF THE PROJECT AND I HAVE NO OBJECTION TO THE SAME.

Signature: _____
Name: _____
Designation: _____
Address: _____

CERTIFICATE OF STRUCTURAL ENGINEER
I, THE UNDERSIGNED, HAVE READ AND UNDERSTOOD THE ENTIRE CONTENTS OF THE ABOVE MENTIONED DRAWING AND SPECIFICATIONS AND I HEREBY CERTIFY THAT THE SAME ARE COMPLETELY ACCORDING TO THE REQUIREMENTS OF THE PROJECT AND I HAVE NO OBJECTION TO THE SAME. I HAVE ALSO READ AND UNDERSTOOD THE ENTIRE CONTENTS OF THE ABOVE MENTIONED DRAWING AND SPECIFICATIONS AND I HEREBY CERTIFY THAT THE SAME ARE COMPLETELY ACCORDING TO THE REQUIREMENTS OF THE PROJECT AND I HAVE NO OBJECTION TO THE SAME.

Signature: _____
Name: _____
Designation: _____
Address: _____

CERTIFICATE OF GEOTECHNICAL ENGINEER
I, THE UNDERSIGNED, HAVE READ AND UNDERSTOOD THE ENTIRE CONTENTS OF THE ABOVE MENTIONED DRAWING AND SPECIFICATIONS AND I HEREBY CERTIFY THAT THE SAME ARE COMPLETELY ACCORDING TO THE REQUIREMENTS OF THE PROJECT AND I HAVE NO OBJECTION TO THE SAME. I HAVE ALSO READ AND UNDERSTOOD THE ENTIRE CONTENTS OF THE ABOVE MENTIONED DRAWING AND SPECIFICATIONS AND I HEREBY CERTIFY THAT THE SAME ARE COMPLETELY ACCORDING TO THE REQUIREMENTS OF THE PROJECT AND I HAVE NO OBJECTION TO THE SAME.

Signature: _____
Name: _____
Designation: _____
Address: _____

PROJECT NAME:
PROPOSED PLAN OF 4th STORED 15.475 METER HEIGHT RESIDENTIAL BUILDING FOR MR. SARANYU NATH CHATTERJEE UNDER RULE 42 OF K.M.C. BLDG. RULES 2008 AT PREMISES NO. 10B, TALTALA LANE, WARD NO. 53, P. S. TALTALA, KOLKATA 700 014, UNDER BURGHUJI (K.M.C.).

STRUCTURAL DRAWING

ARCHITECTURAL CONSULTANT:
JAYDEEP MUKHERJEE
4/2K/5 Ho Chi Min Sarani, Kolkata 700061
Mob: +91-98312 14026
Email: jaydeepz@gmail.com

STRUCTURAL CONSULTANT:
DESIGN MASTERS
Consultant Structural Engineers
17/17/1, LAKE TERRACE, KOLKATA 29
FAX: 2429-1591, MOB: 86000-8648
E-mail: design-masters.2000@gmail.com

DATE: 07.09.2018
DWG SCALE: 1:100 OK AS MENTIONED
SHEET SIZE: A0
CHECKED BY: BLS
DRAWN BY: SPURKAT
DWG NO.: DM/2016/JM/101B TL/STR/01

